

RoHS

HF

Voltage Rating: 50V AC/DC
 Current Rating: 0.5A AC/DC
 Withstand Voltage : 250V AC/minute
 Contact Resistance: 30mΩ(MAX)
 Insulation Resistance: 100MΩ(MIN)
 Temperature Range : -25°C~+85°C

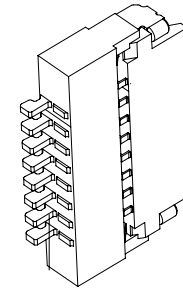
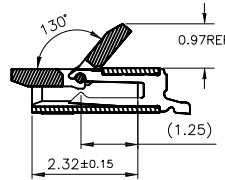
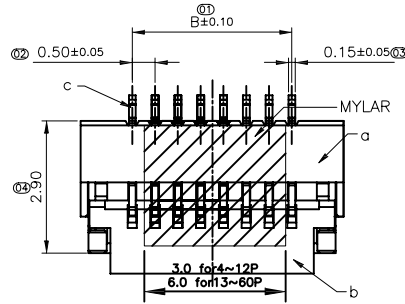

3D Drawing

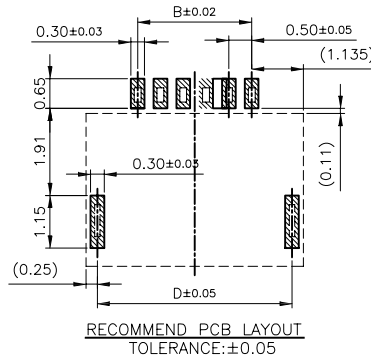
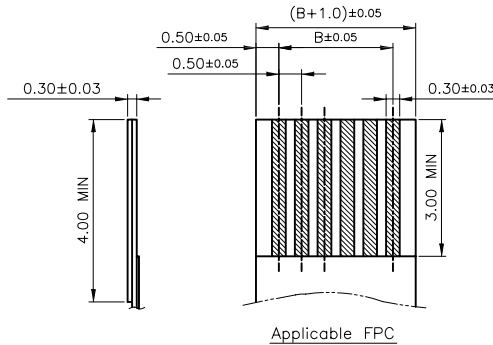
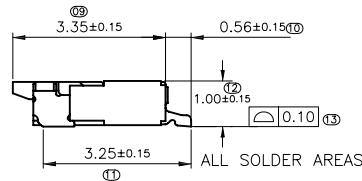
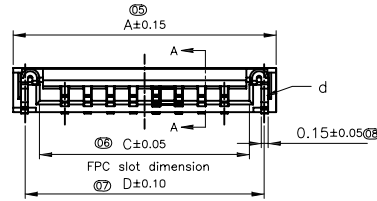

PIN NO.	DIM. A	DIM. B	DIM. C	DIM. D
04	3.77	1.50	2.60	3.27
05	4.27	2.00	3.10	3.77
06	4.77	2.50	3.60	4.27
07	5.27	3.00	4.10	4.77
08	5.77	3.50	4.60	5.27
09	6.27	4.00	5.10	5.77
10	6.77	4.50	5.60	6.27
11	7.27	5.00	6.10	6.77
12	7.77	5.50	6.60	7.27
13	8.27	6.00	7.10	7.77
14	8.77	6.50	7.60	8.27
15	9.27	7.00	8.10	8.77
16	9.77	7.50	8.60	9.27
17	10.27	8.00	9.10	9.77
18	10.77	8.50	9.60	10.27
19	11.27	9.00	10.10	10.77
20	11.77	9.50	10.60	11.27
21	12.27	10.00	11.10	11.77
22	12.77	10.50	11.60	12.27
23	13.27	11.00	12.10	12.77
24	13.77	11.50	12.60	13.27
25	14.27	12.00	13.10	13.77
26	14.77	12.50	13.60	14.27
27	15.27	13.00	14.10	14.77
28	15.77	13.50	14.60	15.27
29	16.27	14.00	15.10	15.77
30	16.77	14.50	15.60	16.27
31	17.27	15.00	16.10	16.77
32	17.77	15.50	16.60	17.27
33	18.27	16.00	17.10	17.77
34	18.77	16.50	17.60	18.27
35	19.27	17.00	18.10	18.77
36	19.77	17.50	18.60	19.27
37	20.27	18.00	19.10	19.77
38	20.77	18.50	19.60	20.27
39	21.27	19.00	20.10	20.77
40	21.77	19.50	20.60	21.27
n	n*0.5+1.77	(n-1)*0.5	n*0.5+0.6	n*0.5+1.27

40504W90-N PA-S H L OA T B M
 ① ② ③ ④ ⑤ ⑥ ⑦ ⑧ ⑨ ⑩

- ① Series NO.
- ② W90: Right Type
- ③ NO. of Circuits
- ④ Color: A=Black
- ⑤ S: SMT type
- ⑥ H=Halogen Free
- ⑦ Material: L=LCP
- ⑧ Plating for contacts:
2E=Matte Tin-plated
- OA=Gold-flash on contact area
- ⑨ Plating for solder area:
T=Matte Tin-plating
- ⑩ Assembly Style
T=Top Contacts
B=Bottom Contacts
- ⑪ M=Reel with mylar Backing

REV.	REVISION RECORD	DATE	GENERAL TOLERANCES		SCALE:1:1	NAME	DATE	WJCT 苏州伟聚电子科技有限公司	PART.ND: 40504W90-NPA-SHLOATBM
			LINEAR	ANGLES	APPROVED				DWG.ND: 40504W90-NPA-SHLOATBM
			0.0 ±0.30	X'REF ± 6°	DESIGNER			REV: A	
			UNIT: MM	0.00 ±0.20	X' ± 3'	DRAWN		SHEET: 1/2	
			SIZE: A4	0.000±0.10	X'X' ± 2'			TITLE: FPC0.5 Pitch 1.0H ZIF R/A Connector	