

RoHS
HF

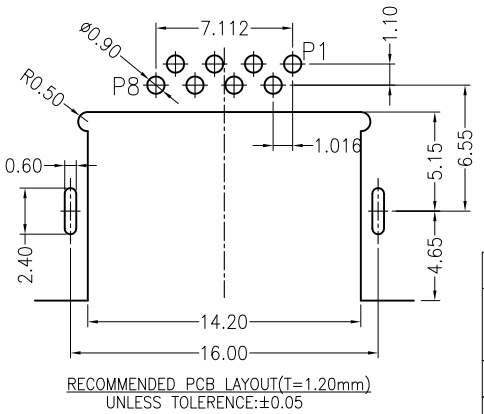
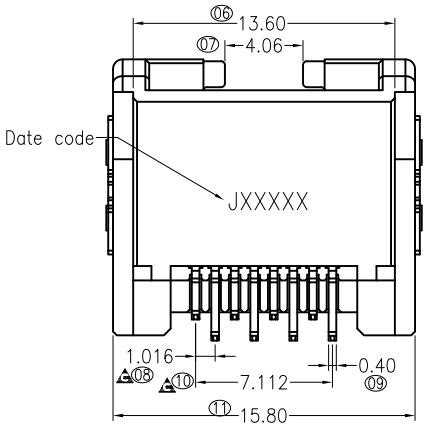
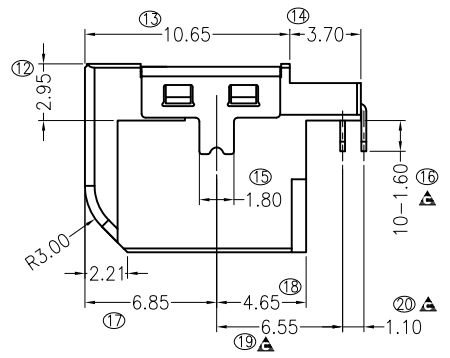
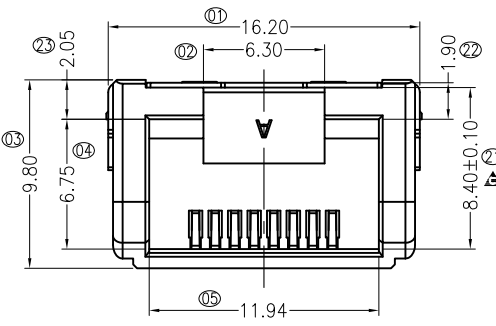
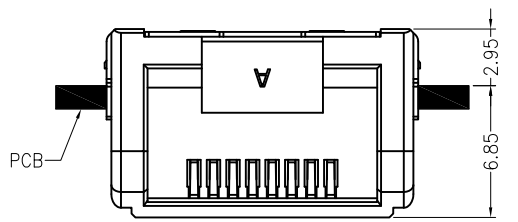
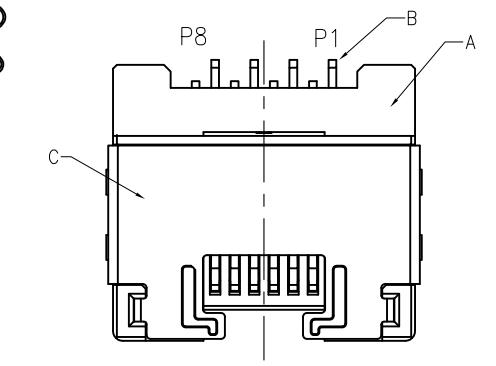

SPECIFICATIONS:

- ELECTRICAL CHARACTERISTICS:
 - CURRENT RATING: 0.5A MAX.
 - VOLTAGE RATING: 5V MAX.
 - CONTACT RESISTANCE : 30mΩ MAX.(INITIAL).
45mΩ MAX.(AFTER LIFE TEST).
 - INSULATION RESISTANCE : 100MΩ MIN.
- MECHANICAL CHARACTERISTICS:
 - DURABILITY: 3000 CYCLES.
 - INSERTION FORCE: 2.25Kg MAX. WITH LATCH DEPRESSED
 - WITHDRAWAL FORCE: 4.5Kg MIN . WITH LATCH DEPRESSED
 - OPERATING TEMPERATURE: -30℃ ~ +70℃.
- ⊙MARK IS FAI DIM. ▲MARK IS CPK DIM.
- PART NO: WRJ10208-0A*0

0: reel packing
1: tray packing
GOLD PLATING

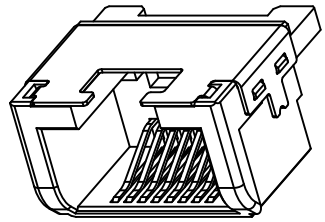

C	SHELL	1	STAINLESS STEEL	NI PLATING ALL OVER
B	CONTACT	8	PHOSPHOR BRONZE	G/F ON CONTACT AREA; Sn 100u" ON SOLDER TAIL ALL OVER Ni 50u"MIN.
A	BODY	1	HIGH TEMP.THERMOPLASTIC	UL 94V-0 & BLACK
NO	DESCRIPTION	QTY	MATERIAL	PLATING & COLOR

REV.	REVISION RECORD	DATE		GENERAL TOLERANCES		SCALE: 1:1	NAME	DATE	 苏州伟聚电子科技有限公司 TITLE: RJ45 H2.95 DIP TYPE	PART.NO: WRJ10208-0A00
				LINEAR	ANGLES	APPROVED				DWG.NO: 650-0000-0002
			UNIT: MM	0.0 ±0.15	X'REF ± 3'	DESIGNER			REV: C	SHEET: 1/1
			SIZE: A4	0.00 ±0.05	X' ± 2'	DRAWN				