

RoHS

HF

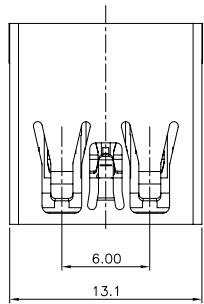

(TOP VIEW)

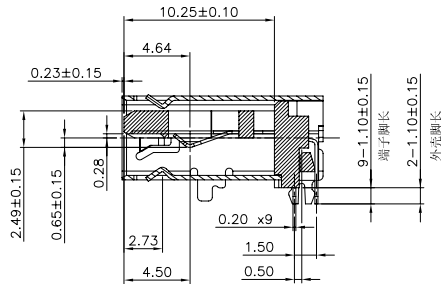

SECTION A-A

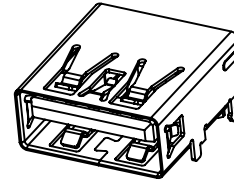

NOTE:

- 1.MATERIAL:
 - 1.1 INSULATOR:PA9T UL 94 V-0;COLOR SEE ITEM5
 - 1.2 CONTACT:C5210-EH(T=0.20mm)
 - 1.3 SHELL:SUS201(T=0.30mm)
- 2.ELECTRICAL CHARACTERISTICS:
 - 2.1 CONTACTRESISTANCE:30mΩ Max
 - 2.2 CONTACT CURRENT RATING:1.5A
 - 2.3 DIELECTRIC WITHSTANDING VOLTAGE:500 V R.M.S.
 - 2.4 INSULATION RESISTANCE 100 MEGOHMS Min
 - 2.5 OPERATING TEMPERATURE:-40°C ~ 85°C
- 3 MECHANICAL CHARACTERISTICS:
 - 3.1 MATING FORCE:35 N Max
 - 3.2 UNMATED FORCE:10 N Min INITIAL; 8 N Min AFTER TEST
 - 3.3 DURABILITY:5,000 CYCLES
- 4.PLATING
 - 4.1 TERMINAL CONTACT:(SEE TAB) GOLD PLATING ALL OVER 50u" MIN NICKEL AND 80u"MIN Tin ALL OVER 50u" MIN NICKEL ON SOLDER AREA
 - 4.2 SHELL:80u"MIN.NICEL ALL OVER
- 5.PART NUMBER RULE

W-26-0134-0900X

INSULATOR COLOR
B: BLACK
U: BLUE

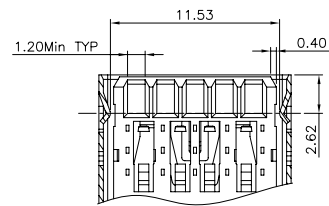
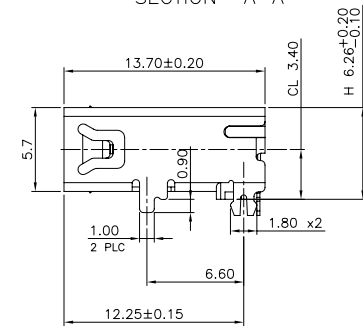
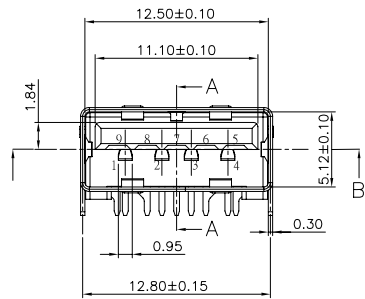

SECTION B-B

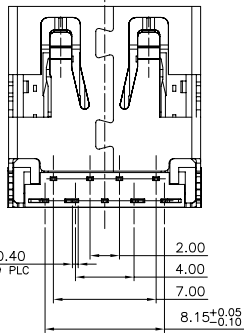

BOTTOM VIEW

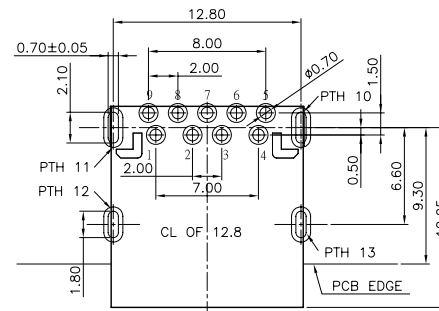

TOLERANCE: ±0.05, THICKNESS: 1.2mm
RECOMMENDED PCB LAYOUT

(TOP VIEW)
KEEP OUT AREA

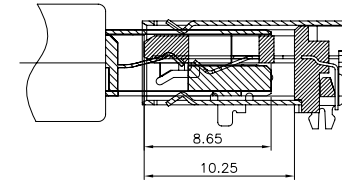

Pin #	SIGNAL NAME	DESCRIPTION	MATING SEQUENCE
1	VBUS	POWER	SECOND
2	D-	USB 2.0 DIFFERENTIAL PAIR	THIRD
3	D+		
4	GND	GROUND FOR POWER RETURN	SECOND
5	Std_A_SSRX-	SUPERSPEED RECEIVER DIFFERENTIAL PAIR	LAST
6	Std_A_SSRX+		
7	GND_DRAIN	GROUND FOR SIGNAL RETURN	
8	Std_A_SSTX-	SUPERSPEED TRANSMITTER DIFFERENTIAL PAIR	
9	Std_A_SSTX+		
Shell	Shield	CONNECTOR METAL SHELL	FIRST

REV.	REVISION RECORD	DATE	GENERAL TOLERANCES	SCALE:	NAME	DATE	<p>苏州伟聚电子科技有限公司</p>	PART NO:				
A	INITIAL RELEASE	05/09/2014	<table border="1"> <tr> <th>LINEAR</th> <th>ANGLES</th> </tr> <tr> <td>0.0 ±0.30</td> <td>X'REF ± 6°</td> </tr> </table>	LINEAR	ANGLES	0.0 ±0.30		X'REF ± 6°	APPROVED	SamTan	10/12' 2015	W-26-0134-0900X
LINEAR	ANGLES											
0.0 ±0.30	X'REF ± 6°											
B	ADD NUMBER RULE DEFINE	10/12/2015	<table border="1"> <tr> <th>UNIT: MM</th> <th>X' ± 3'</th> </tr> <tr> <td>0.00 ±0.20</td> <td>X' ± 3'</td> </tr> </table>	UNIT: MM	X' ± 3'	0.00 ±0.20	X' ± 3'	DESIGNER	SamTan	10/12' 2015	DWG.NO:	
UNIT: MM	X' ± 3'											
0.00 ±0.20	X' ± 3'											
			<table border="1"> <tr> <th>SIZE: A4</th> <th>X'X' ± 2'</th> </tr> <tr> <td>0.000±0.10</td> <td>X'X' ± 2'</td> </tr> </table>	SIZE: A4	X'X' ± 2'	0.000±0.10	X'X' ± 2'	DRAWN	RingWang	10/12' 2015	W-26-0134-0900X	
SIZE: A4	X'X' ± 2'											
0.000±0.10	X'X' ± 2'											
							TITLE:	REV: B	SHEET: 1/1			

USB 3.0 CONNECTOR AF H6.26 L13.7
CL3.40MM STD DIP TYPE