

RoHS  
HF

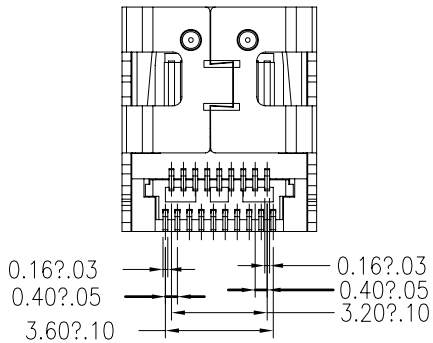

PIN	Signal Assignment	PIN	Signal Assignment
1	Hot Plug Detect	2	Utility
3	TMDS Data2+	4	TMDS Data2 Shield
5	TMDS Data2-	6	TMDS Data1+
7	TMDS Data1 Shield	8	TMDS Data1-
9	TMDS Data0+	10	TMDS Data0 Shield
11	TMDS Data0-	12	TMDS Clock+
13	TMDS Clock Shield	14	TMDS Clock-
15	CEC	16	DDC/CEC Ground
17	SCL	18	SDA
19	+5V Power		

NOTE:  
 1.MATERIAL AND FINISH SEE THE TABLE.  
 2.MECHANICAL CHARACTERISTICS  
 INSERTION FORCE: 44.1N MAX  
 EXTRACTON FORCE: 5N MIN(AFTER 5000 CYCLES 3N MIN.), 25N MAX.  
 MATING CYCLE:5000 CYCLES  
 3.ELECTRICAL CHARACTERISTICS  
 RATING CURRENT: 0.5A  
 RATING VOLTAGE: 40V  
 CONTACT RESISTANCE: 10 MILLOHMS OHMS MAX (EXCLDUING CONDUCTOR RESISTANCE)  
 INSULATION RESISTANCE:  
 a, UNMATED: 100M OHMS MIN AT 500 VDC  
 b, MATED: 10M OHMS MIN AT 150 VDC  
 DIELECTRIC WITHSTANDING VOLTAGE:  
 250V AC/1MINUTE  
 OPERATING TEMPERATURE: -20?--+85?  
 STORAGE TEMPERATURE: -20?--+65?

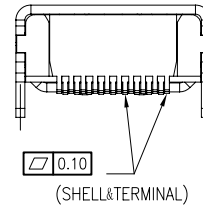
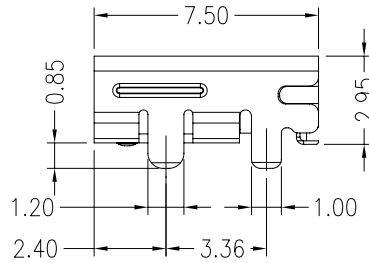
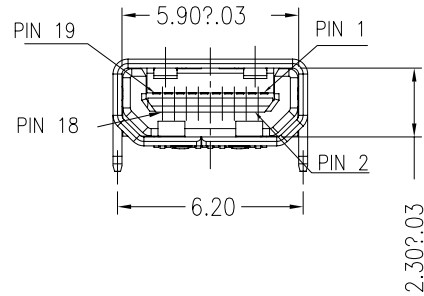
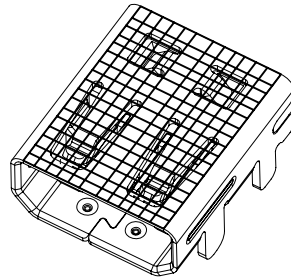
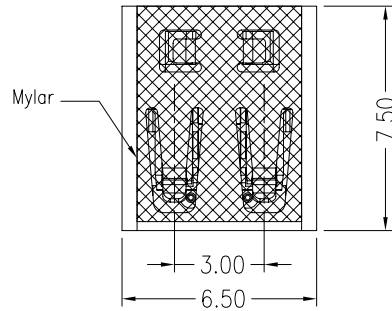
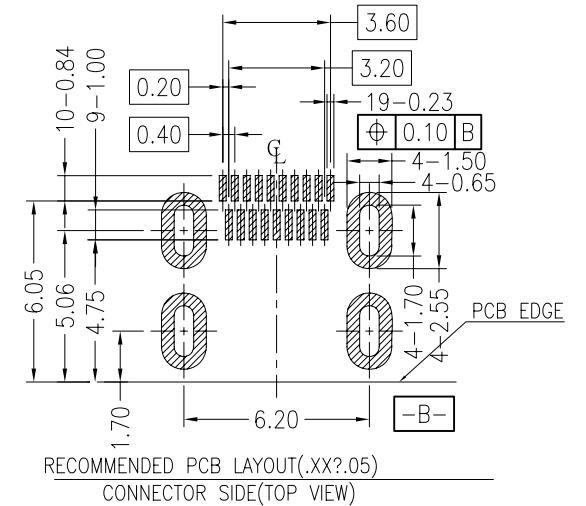

REV.	REVISION RECORD	DATE	GENERAL TOLERANCES		SCALE:1:1	NAME	DATE	<b>WJCT</b> 苏州伟聚电子科技有限公司 TITLE: HDMI D/F TYPE SMT TYPE SHELL LEG DIP+DIP (HSD-1 Series)	PART.NO:
			LINEAR	ANGLES	APPROVED	BingShao	09.19.14		W-00-6002-1900
			0.0 ±0.30	X'REF± 6°	DESIGNER	Peak.ke	09.19.14		DWG.NO:
			UNIT: MM	0.00 ±0.20	X' ± 3'	DRAWN	Chris.Liao		09.19.14
			SIZE: A4	0.000±0.15	X'X' ± 2'			REV: A	SHEET: 1/1